

Assembly of the CR 7 VET

Replacement of transport belt



Repair work on the Scanner beyond normal maintenance procedures must only be carried out by DÜRR MEDICAL trained and certified professionals or our customer service.
The assembly and user instructions manual for the device must also be followed. This gives important information on safety, set-up, electrical connections, disinfection, cleaning, etc.



Remove the plug before opening the Scanner!

Delivery contents

Transport belt2137-993-00

1x Transport belt

2x Pull spring

Tools required

SW 2 Allen key

SW 2.5 Allen key

Bent long nose pliers



- Remove the film tray.

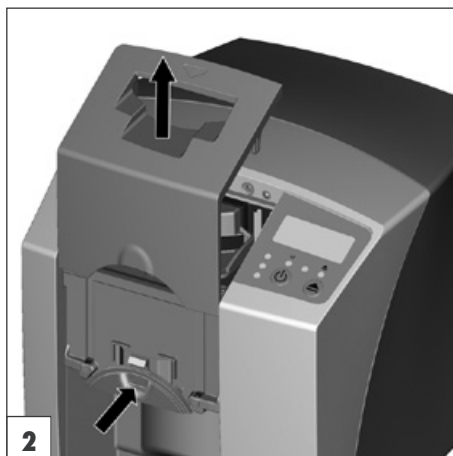

- Press the unlocking button while at the same time lifting the cover up.



- Take out the retaining plate.

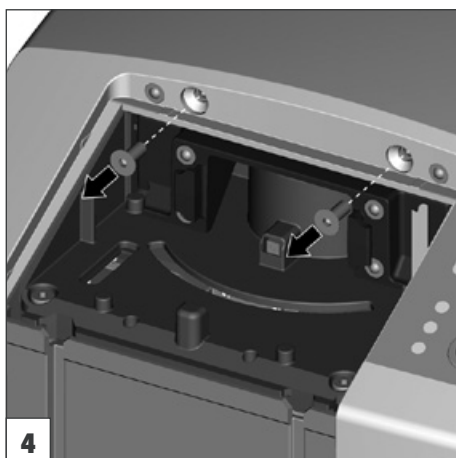

- Remove two countersunk screws with the SW 2.5 Allen key.

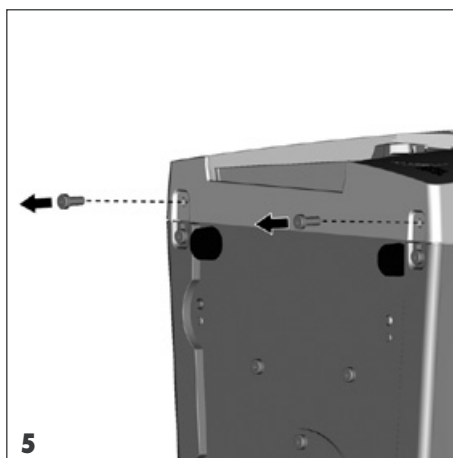

- Remove the socket-head screws underneath with the SW 2.5 Allen key.

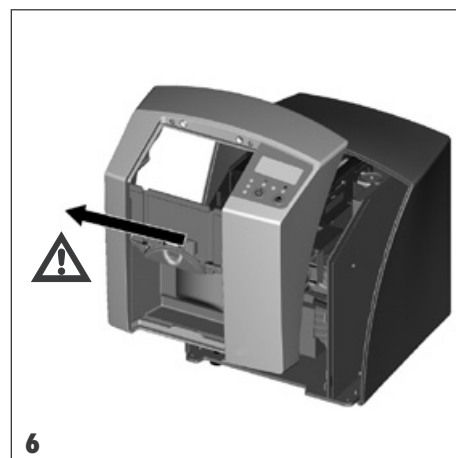

- Lift the front away from the device **very carefully**.



The front is still connected to the device with a ribbon cable. See next step to remove the ribbon cable.

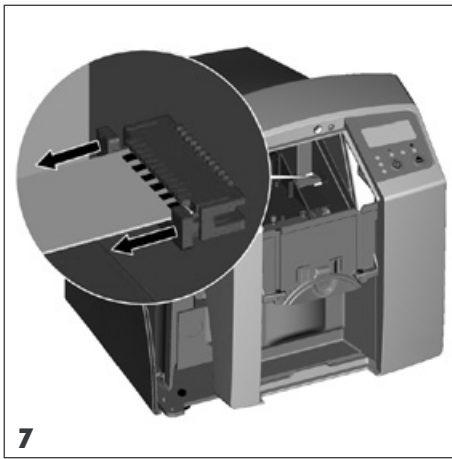

- Unlatch the “Display” socket on the main plate.



The socket is located either at the front or the back of the device depending on the main plate version. If the socket is at the rear of the device, the rear cover must also be removed (four SW 2.5 cylinder screws on the underside; two SW 2.5 counter-sunk screws on the rear).



- Mark the contact positions of the ribbon cable with permanent marker.
- Pull the ribbon cable from the socket.
- Remove the front.

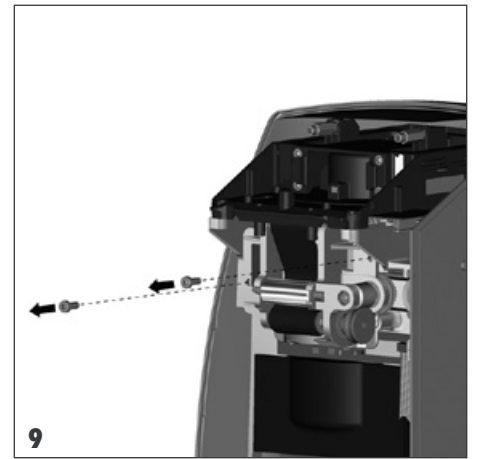

- Remove the socket-head screws from belt drive with the SW 2.5 Allen key.

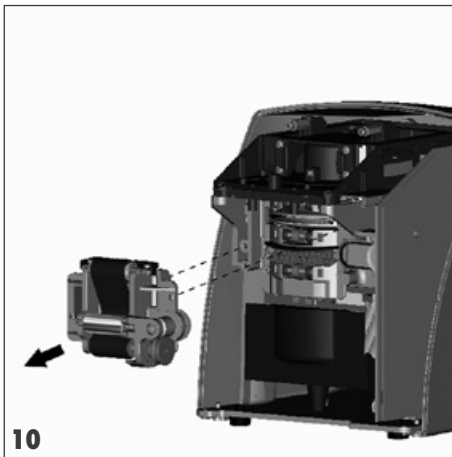

- Remove the belt drive towards the front.

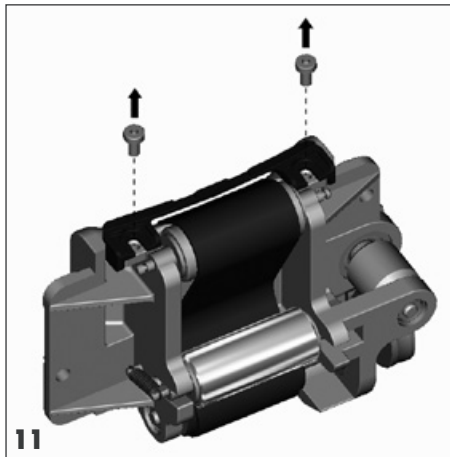

- Remove the socket-head screws on belt drive with the SW 2 Allen key.

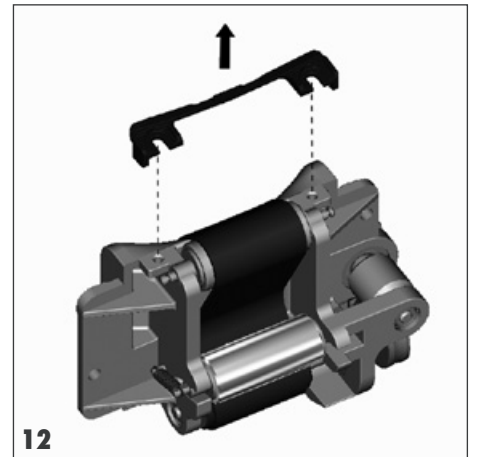

- Remove the guide bar.

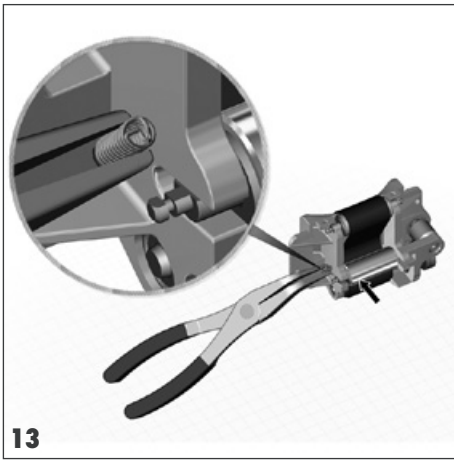

- Unhook the spring with an bent long nose pliers.

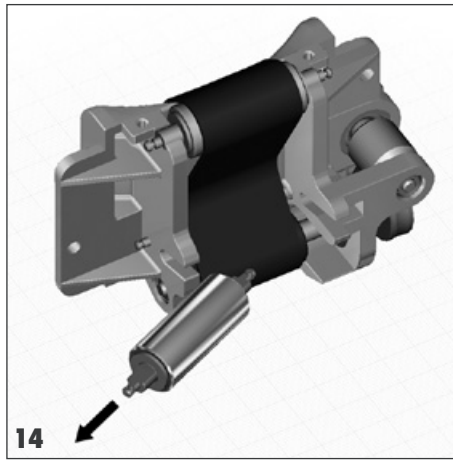

- Unhook the pinch roller on the second spring.

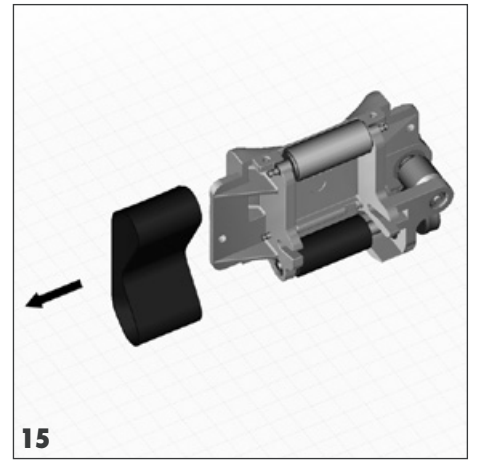

- Remove the old transport belt.

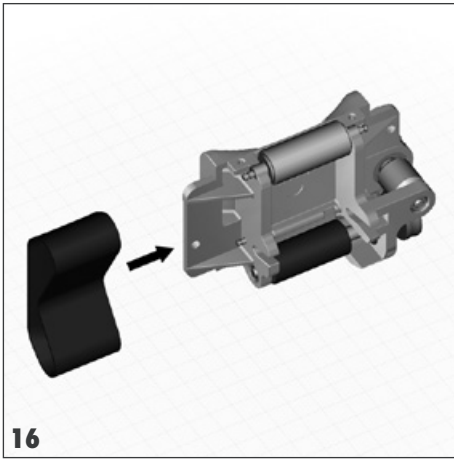

- Place the new transport belt in position.

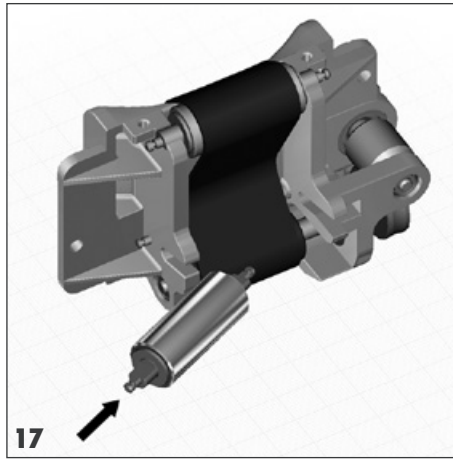

- Place the pinch roller in position.



- Hook the spring.

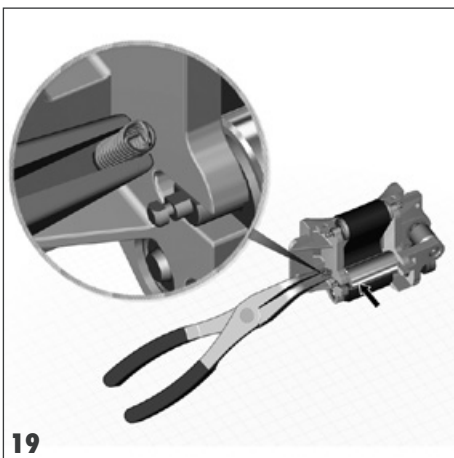

- Press the pinch roller against the transport belt and hook the spring.

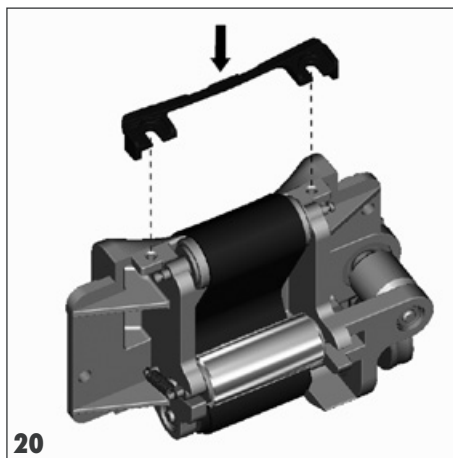

- Place the guide bar in position.

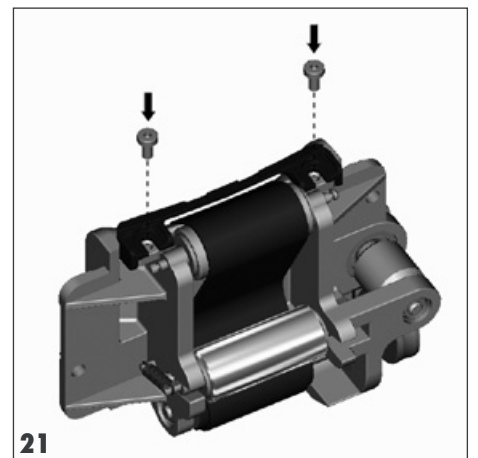

- Attach the two socket-head screws to the guide bar using the SW 2.5 Allen key.

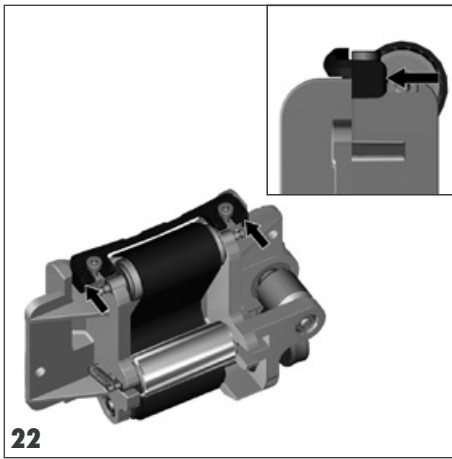

22

- Press the guide bar with the fences to the base body and tight the screws simultaneously.



With overtighten screws (max. 40 Ncm) the guide rail will bent.

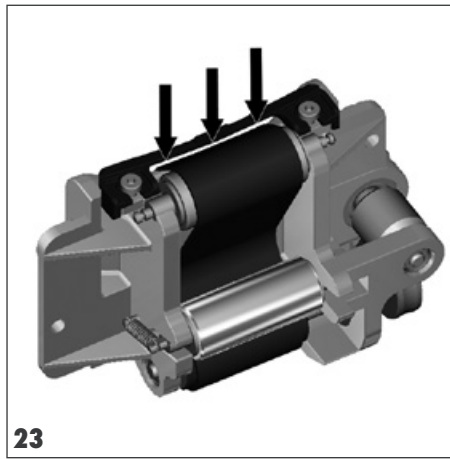

23

- Check the gap between the guide bar and the transport belt. The gap must be constant over the hole width.



24

- Place belt drive in position.



The drive belt must be pulled over the belt coupling of the motor and the belt drive when placed in position.

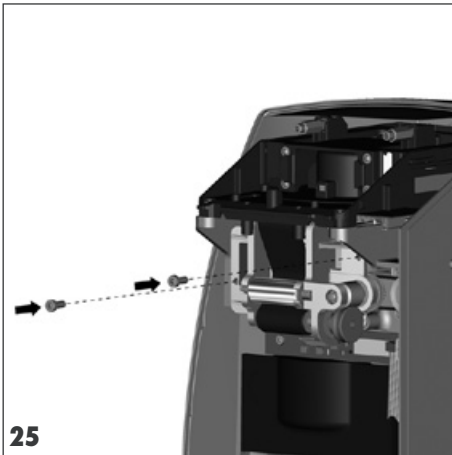

25

- Fix the belt drive in place using two socket-head screws and the SW 2.5 Allen key.



26

- Put the front in place.
- Put the ribbon cable into the socket.



Check the position of the contacts!



27

- Latch the socket.



28

- Put the front into place.



The ribbon cable must be placed in such a way that it won't be crushed or damaged preventing it from working correctly.

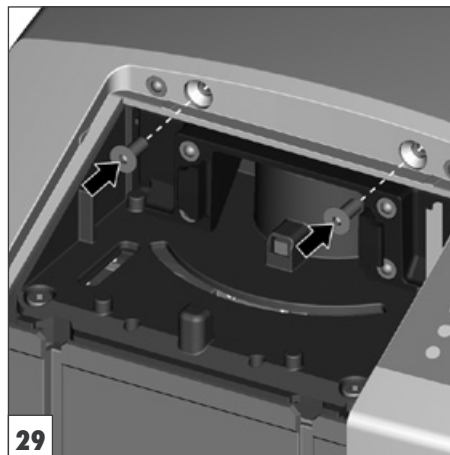

29

- Insert two countersunk screws with the SW 2.5 Allen key.

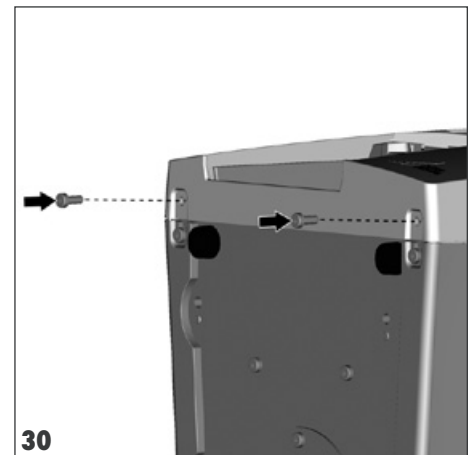

30

- Insert two cylinder screws on the underside with a SW 2.5 Allen key.

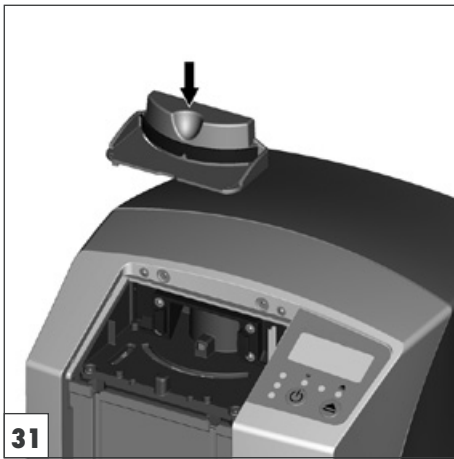

31

- Insert the retainer.



32

- Click the retainer into place in the device and put the cover back into place at the same time.



33

- Put back the film tray.

Test 1:

- Switch unit on.
- Monitor the initialisation sequence (text is displayed on panel clearly, locking plate moves, drive starts, erasure unit lit).



There must be no unusual noises and nothing should appear on the display which are not expected from the unit.

Test 2:

- Scan an evenly homogenously exposed image plate.
- Check the X-ray for signs of artefacts or irregularities.



There must be no signs of artefacts or irregularities.

